

# EDC SERIES

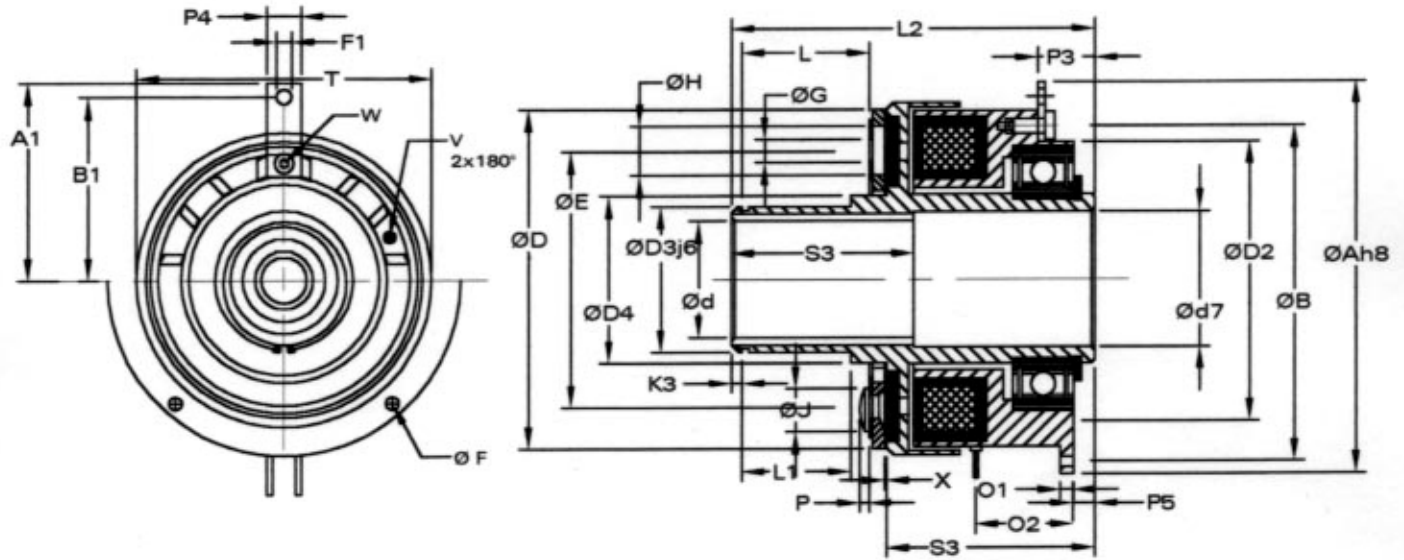

SR.NO.	1	2	3	4	5	6	7
SIZE	06	07	08	09	10	11	12
Torque(Nm)	7	15	30	65	130	250	500
P [W]	15	20	26	35	50	55	85
A	80	100	-	-	-	-	-
A1	-	-	62.5	75	85	115	145
B	72	90	-	-	-	-	-
B1	-	-	56	68.5	67.5	107.5	135
C1	30	40	45	60	65	100	125
D	63	80	100	125	160	200	250
D2	-	-	65	95	126	126	180
D3	25	35	40	50	70	70	50
D4	28	40	46	57	76	78	89
d4	18	26	30	38	55	85	65
d7	17	25	28.5	33	41	48	52
d max	18	22	25	35	50	50	60
E	50	60	76	85	120	136	210
E1	-	-	45.75	55	72.5	88	110
E2	44	68	80	100	140	165	215
F	4x4.5	4x4.5	-	-	-	-	-
F1	-	-	6.5	6.5	9	9	11
G	3x4.1	3x4.1	3x5.1	3x6.1	3x8.1	3x10.1	4x12.1
H	10	11	11.5	15	21	25	26
J	8	8	10	11.5	14.5	17.5	20.5
J3	2	4	4	4	8	8	8
K3	2.1	2.8	3.15	3.2	4	4	4
L	32.8	37.7	35.2	37.6	47.8	47.5	59.6
L1	25.6	29.8	32.15	34.6	43.1	43.3	55.3
L2	80	80	96	103	126	134	182
L3	117	128	141	160	200	217	260
M2	30	30	35	45	50	65	80
M3	24	24	26	32	46	58	70
M4	18	20	23	31	40	40	48
O1	3	3	-	-	-	-	-
O2	19	21.5	24	25	31.5	32.5	41
P	2	2	2.5	3	4	4.5	5
P3	-	-	16.2	18.7	21.5	23	27
P4	-	-	12	14	14	20	22
P5	4	4.5	5.5	5.5	7	7	8
S3	41	43	51.5	55	65	71	85
T	67	65	106	133	169	212.5	268
T1	56	85	100	120	170	200	250
V	-	-	M5	M8	M8	M10	M10
W	-	-	M4	M5	M5	M6	M8
W1	-	-	48.5	35	72.5	88	110
W2	2x1.6	2xM8	3xM8	3xM10	3xM14	3xM16	3xM20
X	0.2	0.2	0.2	0.3	0.3	0.4	0.4
Z	M5	M8	M5	M10	M10	M12	M12